

RL VENTED COMB FILLER

For Ultratherm MSR Roofing Systems

Prevents entry of birds and nesting insects



RL Vented Comb Filler

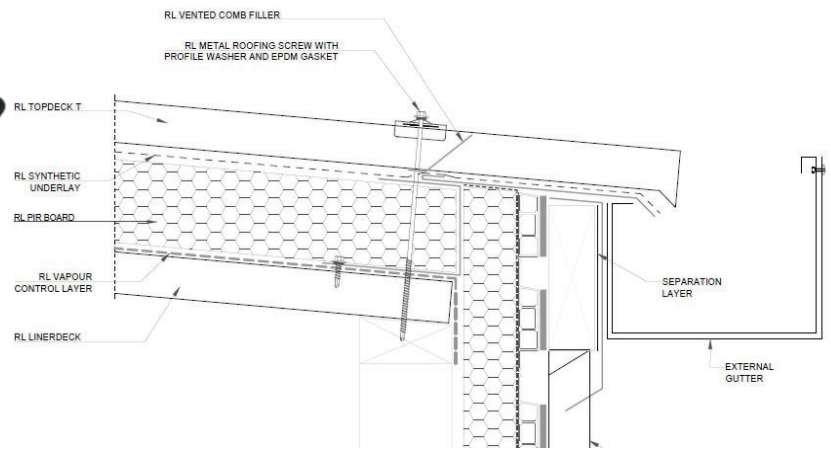

RL Vented Comb Filler indicative detail on RL Ultratherm MSR

DESCRIPTION

Crafted with flexible fingers, the RL Vented Comb Filler is designed to adapt and fill the gaps commonly encountered when using steel roof cladding. It serves as an effective barrier to prevent the entry of birds and larger insects beneath the metal. By closing off these gaps, the RL Vented Comb Filler gives enhanced protection.

BENEFITS

- The RL Vented Comb Filler delivers reliable protection against birds and nesting insects. It presents a cost-effective alternative to purpose-made profiled fillers.
- Conveniently designed in 1-meter lengths, the RL Vented Comb Filler ensures easy installation.
- Its straightforward installation process enables quick and efficient securing, creating a seamless barrier.

MATERIAL AND FINISH

Manufactured through injection molding using Polypropylene material, the RL Vented Comb Filler is available in black. The comb features a 4 mm grille for ventilation.

It is supplied in lengths of 1000 mm.

Colour	Black
Length	1000 mm
Vent Size	4 mm grille
Packing	Sold per Lm